

### Model: 30217T71J2/QDB

Basic size of  
mm

d:	85
D:	150
T:	71

The basic rated load is  
kN

trends C:	303
static state Co:	440
Fatigue load limit Pu:	51

Rated rotation speed is  
r/min

Refer to the speed:	2600
limit speed:	4300
quality:	4.1
model:	30217T71J2/QDB

Dimensions are  
mm

d:	85
d <sub>1</sub> ~ :	112
C:	58.5
r <sub>1,2</sub> the min:	2.5
r <sub>5</sub> the min:	0.6
a:	71
Cb the min:	95

Shoulder gear and chamfer size  
mm

d <sub>b</sub> the max:	141
Dbthe min:	6.5
r <sub>a</sub> the max:	2
r <sub>c</sub> the max:	0.6

Calculation coefficient

e:	0.43
Y1:	1.6

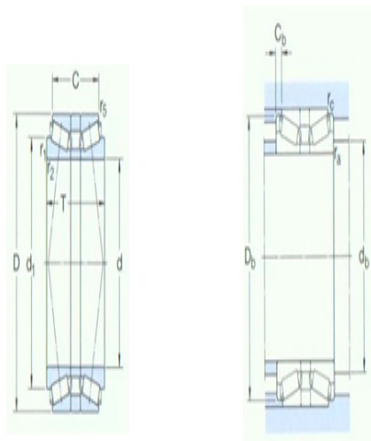

Y2:	2.3
Yo:	1.6