



Model: T7FC055T73/QCL7CDTC10

Basic size of mm

d:	55
D:	115
T:	73

The basic rated load is kN

trends C:	250
static state Co:	325
Fatigue load limit	39
Pu:	

Rated rotation speed is r/min

Refer to the speed:	3400
limit speed:	5600
quality:	3.5
model:	*T7FC055T73/QCL7CDTC10

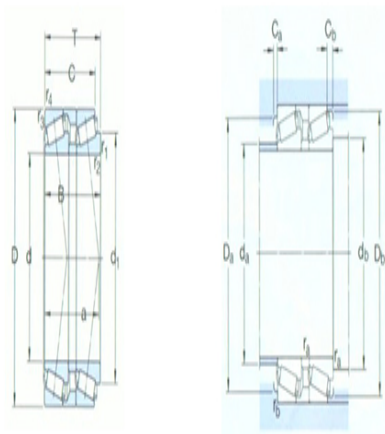

Dimensions are mm

d:	55
d ₁ ~ :	90
B:	70
C:	62.5
r _{1,2} the min:	3
r _{3,4} the min:	3
a ~ :	78

Shoulder gear and chamfer size mm

d _a the min:	66
d _b the min:	67
Da the min:	86
Da the max:	101
Db the min:	109

Ca the min:	4
Cb the min:	10.5
r _a the max:	2.5
r _b the max:	2.5

Calculation coefficient

e:	0.88
Y1:	0.68
Yo:	0.4