

Model: T7FC070T83/QCL7CDTC

10

Basic size of
mm

d:	70
D:	140
T:	83

The basic rated load is
kN

trends C:	355
static state Co:	480
Fatigue load limit	55
Pu:	

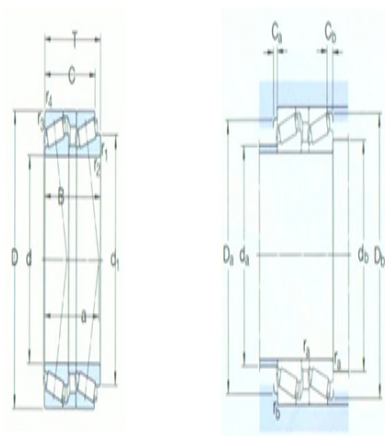

Rated rotation speed is
r/min

Refer to the speed:	2800
limit speed:	4500
quality:	11
model:	*T7FC070T83/QCL7CDTC1 0

Dimensions are
mm

d:	70
d ₁ ~ :	110
B:	79.5
C:	71
r _{1,2} the min:	3
r _{3,4} the min:	3
a ~ :	47

Shoulder gear and chamfer size
mm

d _a the min:	82
d _b the min:	82
Da the min:	106
Da the max:	126
Db the min:	133

Ca the min:	5
Cb the min:	12
r _a the max:	2.5
r _b the max:	2.5

Calculation coefficient

e:	0.88
Y1:	0.68
Yo:	0.4