



**Model: T7FC080T98/QCL7CDTC  
 20**

Basic size of  
 mm

d:	80
D:	160
T:	98

The basic rated load is  
 kN

trends C:	450
static state Co:	630
Fatigue load limit	71
Pu:	

Rated rotation speed is  
 r/min

Refer to the speed:	2400
limit speed:	4000
quality:	16.5
model:	*T7FC080T98/QCL7CDTC2 0

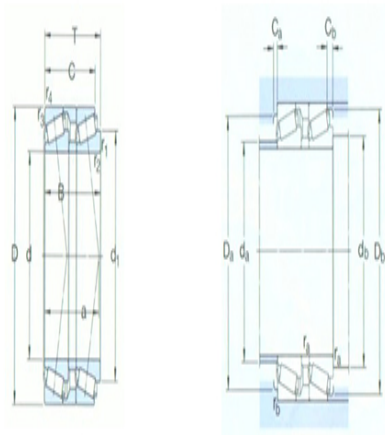

Dimensions are  
 mm

d:	80
d <sub>1</sub> ~ :	125
B:	94
C:	84
r <sub>1,2</sub> the min:	3
r <sub>3,4</sub> the min:	3
a ~ :	106

Shoulder gear and chamfer size  
 mm

d <sub>a</sub> the min:	94
d <sub>b</sub> the min:	92
Da the min:	121
Da the max:	146
Db the min:	152

Ca the min:	5
Cb the min:	14
r <sub>a</sub> the max:	2.5
r <sub>b</sub> the max:	2.5

Calculation coefficient

e:	0.88
Y1:	0.68
Yo:	0.4