

Model: TMFN23-30

size

G:	M 115×2
d <sub>1</sub> :	137
d <sub>3</sub> :	150
B:	19
b:	12
h:	5
Axial load carrying capacity is static:	315
quality:	0.91

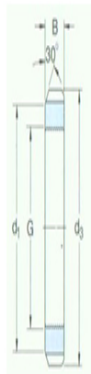

model

locknut:	KM23
Applicable lock washer:	MB23
spanner:	TMFN2 3-30