

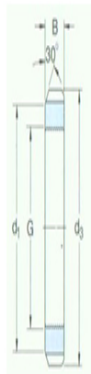

Model: TMFN30-40

size

G:	M 160×3
d <sub>1</sub> :	182
d <sub>3</sub> :	210
B:	25
b:	16
h:	7
Axial load carrying capacity is static:	585
quality:	2.29



model

locknut:	KM32
Applicable lock washer:	MB32
spanner:	TMFN3 0-40