

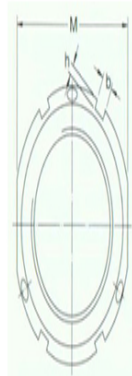

**型号: KMT0**

**尺寸**

G:	M 10×0.75
d <sub>1</sub> :	21
d <sub>2</sub> :	28
d <sub>3</sub> :	23
d <sub>4</sub> :	11
B:	14
b:	4
h:	2
M:	24
轴向负荷承载能力静态:	35
拧松扭矩:	15
质量:	0.045

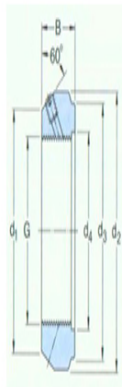

**型号**

锁紧螺母:	KMT0
适用扳手:	HN2/3

**沉头螺钉**

尺寸:	M5
建议锁紧扭矩:	4.5