

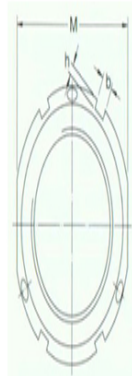

型号: KMT19

尺寸

G:	M 95×2
d ₁ :	117
d ₂ :	130
d ₃ :	120
d ₄ :	98
B:	32
b:	10
h:	4
M:	-
轴向负荷承载能力静态:	710
拧松扭矩:	780
质量:	1.25

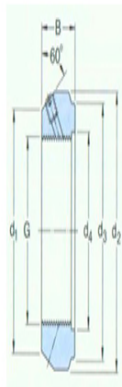

型号

锁紧螺母:	KMT19
适用扳手:	HN19/20

沉头螺钉

尺寸:	M10
建议锁紧扭矩:	35