

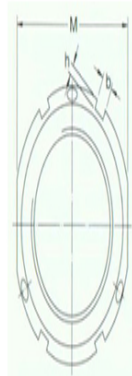

型号: TMFN30-40

尺寸

G:	M 180×3
d ₁ :	202
d ₂ :	215
d ₃ :	204
d ₄ :	182
B:	32
b:	16
h:	7
M:	
轴向负荷承载能力静态:	1220
拧松扭矩:	1900
质量:	2.3

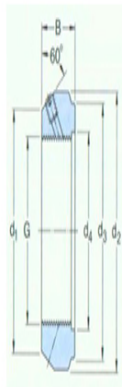

型号

锁紧螺母:	KMT36
适用扳手:	TMFN30-40

沉头螺钉

尺寸:	M10
建议锁紧扭矩:	35